

WHO ARE WE?

Drain-Plane was developed by G.P. Williams, a product development company created to produce innovative, problem-solving products for the construction industry.

Established in 2007, G.P. Williams is a partnership of industry professionals. Together they have over 18 years of experience working in the construction industry with particular emphasis on products related to construction defect restoration or repair.

Recognizing the need for a simpler drainage plane furring device, G.P. Williams developed Drain-Plane. With the development of Drain-Plane, G.P. Williams has brought the reality of a simple, affordable, high quality solution to the moisture intrusion market.

Recognizing that eventually all types of cladding will allow some moisture to penetrate, section R703.1 of the International Residential Code (IRC) was modified in 2006 to require “a means of draining water that enters the assembly to the exterior.”

Drain-Plane
www.drain-plane.com

5866 Blackshire Path
Inver Grove Heights, MN 55076

Drain-Plane

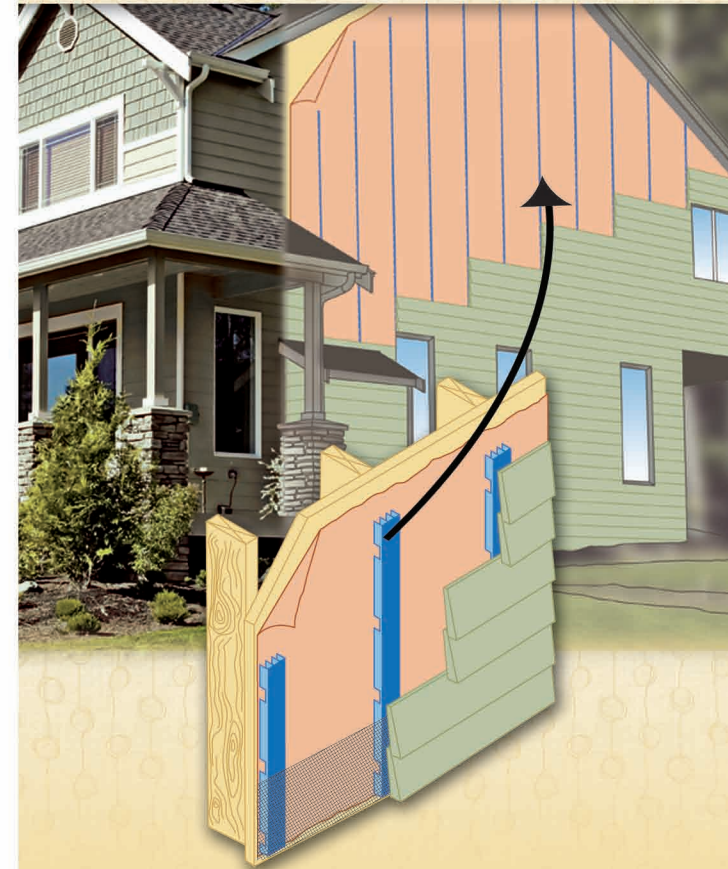

MOISTURE PROTECTION PLANE & SIMPLE

www.drain-plane.com

877-457-2011

Patent Pending

WHAT IS DRAIN-PLANE?



Drain-Plane protects your home or building against the damaging effects of moisture. It is a critical component for preventing water intrusion. It is

ventilated vertically and horizontally to create a superior drainage and airflow cavity behind the exterior wall cladding.

Drain-Plane is installed over the water resistive house wrap on the exterior wall under the cladding. Drain-Plane's channels allow for the majority of moisture to leave the cavity. Its airflow cavity promotes drying of any remaining moisture. The result is a drier and more durable wall assembly.

What People are Saying

"Drain-Plane makes it very simple to physically show the homeowner the benefits of creating an airspace behind the siding. It is an easy product to sell and most of our customers say, "We understand it, great idea, let's go with the Drain-Plane option!"

William S. Illetschko
Krech Exteriors



MAKES SENSE FOR THE HOMEOWNER

The Benefits of Drain-Plane:

- ▶ Vertical and horizontal airflow cavity.
- ▶ A fully integrated rain screen system is created throughout the exterior envelope by installing Drain-Plane up into the soffit.
- ▶ Creates air space, providing a thermal break and energy savings.
- ▶ Increased longevity of your cladding and less need for repainting because Drain-Plane protects the durability of your cladding.
- ▶ Tests show a reduced chance of siding blow-offs in high wind conditions.

Use Drain-Plane Under:

- ▶ Fiber Cement Planks and Shakes
- ▶ Lap Siding
- ▶ Flat Panels
- ▶ Steel
- ▶ Cedar Siding and Shakes
- ▶ Aluminum
- ▶ Vinyl
- ▶ Foam-Backed Cladding
- ▶ And Others...

MAKES SENSE FOR THE SIDING CONTRACTOR

Drain-Plane Advantages

- ▶ The 6 foot strips install quickly and easily on the studs of the exterior wall.
- ▶ Is easily sized to fit any size or shape wall.
- ▶ Compatible with a wide variety of cladding including lap, shingle, and panel products. It even works with commercial panels without blowing out the panels.
- ▶ Marks the studs making easier installation of cladding, trim boards and soffits.
- ▶ Does not compress, therefore reducing any likelihood of a "waving" effect in the cladding, as is the potential with poly-mesh products.

INSTALLATION OVERVIEW

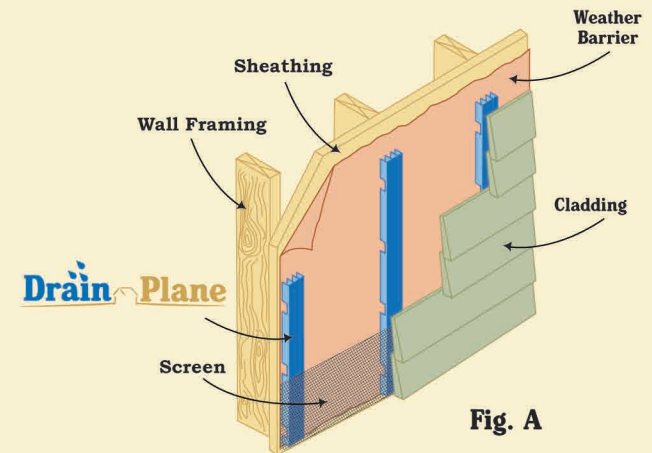

Installation instructions available at
www.drain-plane.com

PATENT PENDING